

2014

ROUND POST TRIANGULAR SLIP BASE SYSTEM



TRINITY
HIGHWAY

SSS06 a-b

SHEET NO.

DATE

1 of 4

6/2/2016

INTENDED USE

The POZ-LOC triangular slip base, tubular, sign support system is a single-post sign support system. Two posts may be used as long as the posts are no more than 84 inches [2134 mm] apart. These systems are designed to be set in concrete footings and have been tested to satisfy the requirements of the 2007 AASHTO *Standard Specifications for Structural Supports for Highway Signs, Luminaires and Traffic Signals*.

COMPONENTS

The components of the POZ-LOC triangular slip base system include the steel tube post (PTP02 a-c), slip base casting, bolt retainer plate and nuts and bolts and washers, and the set screws. Except for the slip base casting, which acts as the post retainer, the system is similar to the generic, fabricated triangular slip base. The advantage of this system is that no weld fabrication is required and the post is easily replaced after an impact event. The slip base bolts and nuts shall be tightened to a torque of between 38 - 80 ft. lb [52 - 108 Nm]. Lubrication of the slip base nuts is not required when the bolts are being tightened.

The triangular slip base ground stub is made from ASTM A53 Grade B pipe and ASTM A36 steel plate. The ground stub assembly is galvanized after fabrication per ASTM A123 G85 min (AASHTO M111).

The bolt retainer plate is used to align the bolts and retain them in place under service loads. The plate is fabricated from ASTM A653 G90 steel sheet, thickness range 0.0157 - 0.0217 in [0.4 - 0.55 mm].

The slip base casting is made from ASTM A653 Grade 64-45-12 ductile iron and galvanized per ASTM A123 or ASTM A153(AASHTO M232).

APPROVALS

FHWA Acceptance Letter HSSD/SS-128 Revised, September 5, 2008

CONTACT INFORMATION

2525 North Stemmons Freeway
Dallas, TX 75207
Telephone: (888) 323-6374
Fax: (800) 770-6755
<http://www.highwayguardrail.com/>

ROUND POST TRIANGULAR SLIP BASE SYSTEM

SSS06 a-b

SHEET NO.

DATE

2 of 4

6/2/2016



TRINITY
HIGHWAY

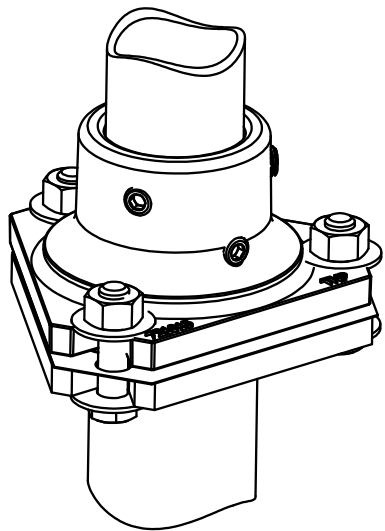

ASSEMBLY VIEW

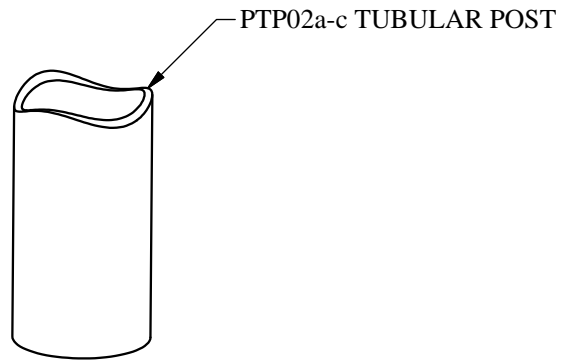

PTP02a-c TUBULAR POST

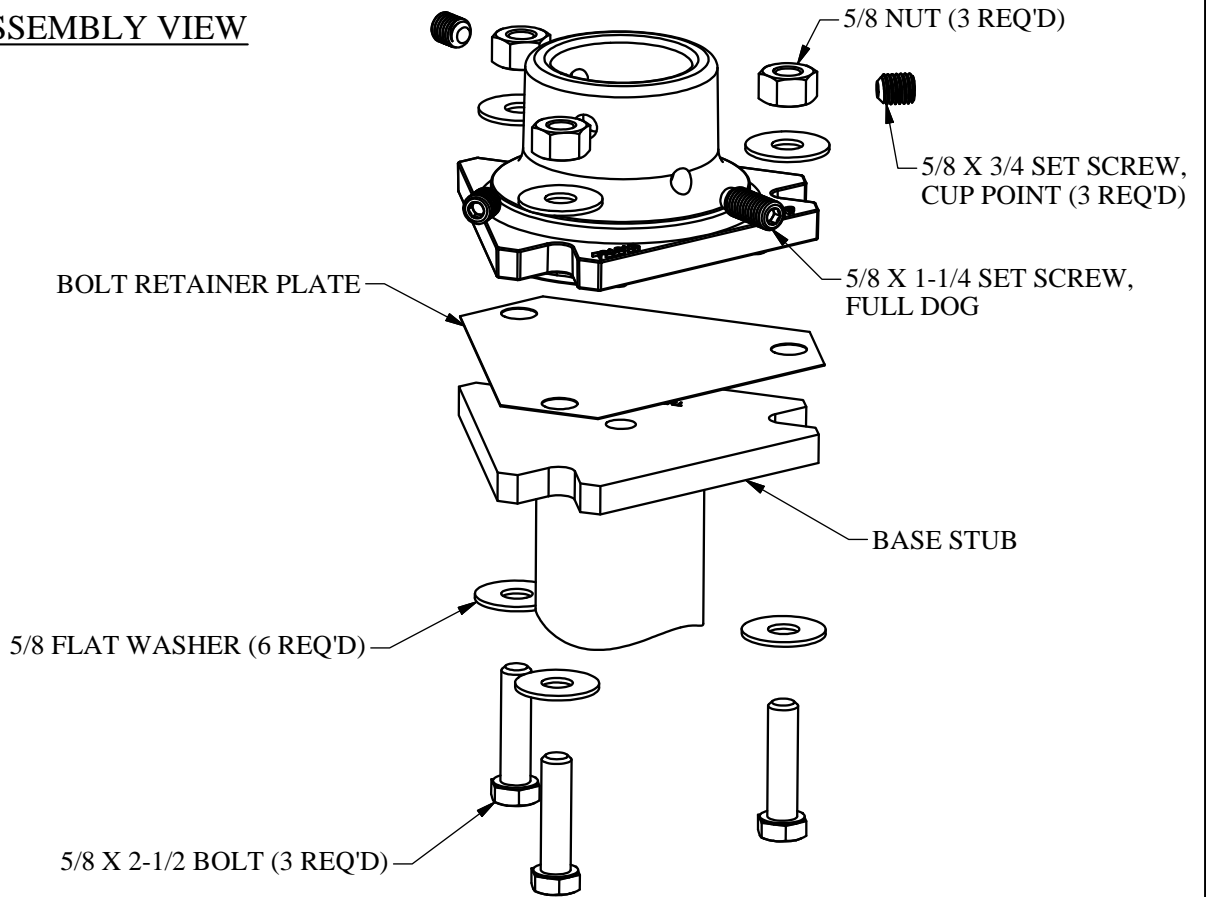

EXPLODED VIEW

BOLT RETAINER PLATE

5/8 NUT (3 REQ'D)

5/8 X 3/4 SET SCREW, CUP POINT (3 REQ'D)

5/8 X 1-1/4 SET SCREW, FULL DOG

BASE STUB

5/8 FLAT WASHER (6 REQ'D)

5/8 X 2-1/2 BOLT (3 REQ'D)

2014

ROUND POST TRIANGULAR SLIP BASE SYSTEM



TRINITY
HIGHWAY

SSS06 a-b

SHEET NO.

DATE

3 of 4

6/2/2016

This page left blank

ROUND POST TRIANGULAR SLIP BASE SYSTEM

SSS06 a-b



TRINITY
HIGHWAY

SHEET NO.

DATE

4 of 4

6/2/2016